

Compact unit can be mounted on walls above sinks and in other tight spaces

Electrolyzed Water Production System

Direct Output Type

ROX-10WB

Wall-Mounted Type

Daily Output Capacity

Alkaline Electrolyzed Water (Cleaning Water) **Approx. 1.5~2.1t**

Acidic Electrolyzed Water (Sanitizing Water) **Approx. 1.5~2.1t**



Sanitary touchless operation - emit water just by holding up your hand to the sensor.

The unit features a built-in contactless sensor. Just hold your hand up to the sensor; the sensor detects your hand and automatically emits electrolyzed water. The system is very sanitary, as it outputs water without hand contact.

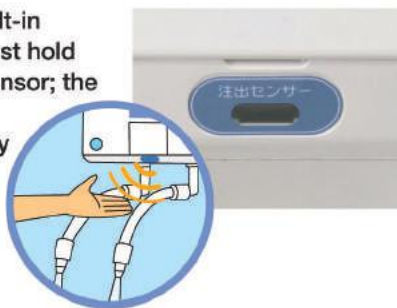

Equipped with Easy-to-Use Flex Nozzles.

These units feature flexible pouring nozzles that can be bent to any desired angle. The nozzle also can be switched to emit water in a shower flow.



Emit Continuously or at Predetermined Times.

The system features two output modes, a normal mode that provides a continuous stream only when and in the amount needed, and one that allows users to set a timer and have the stream start and automatically shut off at preset times. This is a convenient feature for tasks such as filling sinks with electrolyzed water.

Indicator and Control Panels Are Easy to Read and Use.

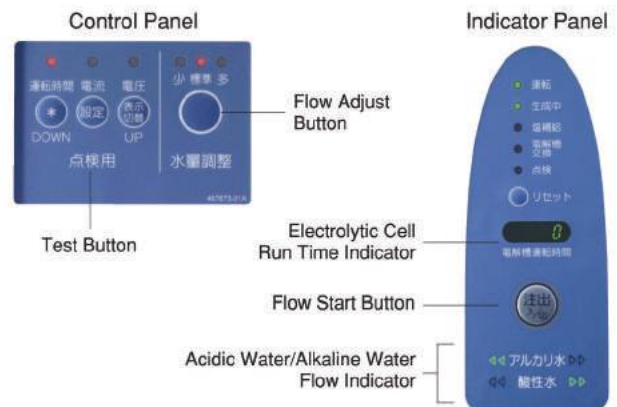

Adjust Flow Rate Easily with a Single Button.

The flow rate can be adjusted just by pressing the control panel's flow adjustment switch. Select from "Low," "Standard," and "High" flow rates.

※Output capacity may not increase if supply water pressure is insufficient.

Alkaline Electrolyzed Water (Cleaning Water) **Approx. 1.5L/min**

Acidic Electrolyzed Water (Sanitizing Water) **Approx. 1.5L/min**

Flow Adjustment Criteria



Sample Installation



ROX-10WB

Power Supply	Single-phase 100 V, 50/60 Hz, 0.5 kVA (5.0 A)	
Power Consumption	150/150 W	
Standard Performance	Electrolyzed Water Output	Acidic electrolyzed water (sanitizing water), alkaline electrolyzed water (cleaning water): approx. 1.0 L/min
	Available Chlorine Concentration	Acidic electrolyzed water (sanitizing water): 20-60 mg/kg
	Electrolyzed Water pH	Acidic electrolyzed water (sanitizing water): approx. 2.7 or under; Alkaline electrolyzed water (cleaning water): approx. 11.3 or above (with Toyoake City water)
Reference Performance	Electrolyzed Water Output	Acidic electrolyzed water (sanitizing water), alkaline electrolyzed water (cleaning water): approx. 0.7-1.5 L/min (however, minimum supply water pressure of 0.15 MPa required for generation at 1.0-1.5 L/min)
	Available Chlorine Concentration	At production rate of approx. 1.5 L/min: ACC for acidic electrolyzed water (sanitizing water): 10 mg/kg or above
Exterior Dimensions	Electrolyzed Water pH	Acidic electrolyzed water (sanitizing water): approx. 2.9-3.3; alkaline electrolyzed water (cleaning water): approx. 10.5-11.0 or above (Note) May vary according to quality of water source and water temperature.
	Weight	W: 350 mm x D: 174 mm x H: 340 mm
Connections	Supply: G3/4 (reducing valve G1/2); outlet G1/2	
Water Supply	Must conform to waterworks standards, with water softener and filter required	
Usage Temperature Range	Approx. 13 kg (16 kg packaged)	
Installation Siting	Must meet interior specifications, with ventilation required	
Allowable Voltage Range Salt	Concentrated salt tank (5 L), cap, hose/water supply, nozzle hoses (2), pH tester (TB, AZY), chlorine tester, beaker, gasket, reducing valve (0.15MPa) operation instruction sheet, screw collar, anchor plug, wood screw, rubber syringe, shower nozzle, straight nozzle, O-ring, elbow fitting AY	
Accessories	±10% of rated voltage Table salt (sodium chloride) from Salt Industry Center of Japan (min purity 99%)	

<Important Notes>
 1. Grounding is mandatory. 2. Environment must be free of dust, with good ventilation. 3. Piping outside equipment must be insulated, condensation is not permissible. 4. Pipe resistance in piping outside equipment must be uniform. 5. Rated values indicated are measured values based on technical standards for electric devices, with 30°C ambient temperature, water temperature of 25°C, water supplied by Toyoake City. 6. Optional Hoshizaki TDT-15WB2 Holding Tank Unit is available if 3-5 L/min performance is desired. 7. Notes regarding installation requirements: Ensure system is used properly in accordance with conditions regarding placement, water supply and drainage, power supply, and other stipulations in the operation manual and installation manual. As actual space for installation may differ slightly, allow approximately 10 mm additional space in dimensions (space for ventilation and piping is in addition to the space required for installation of the unit).

TDT-15WB2 Holding Tank Unit for ROX-10WB (Optional)

Power Supply	Single-phase 100 V, 50/60 Hz, 0.23 kVA (2.3 A)
Power Consumption	22/23 W
Output	Acidic electrolyzed water (sanitizing water): approx. 3/5 L/min (1 m head, 50/60 Hz); Alkaline electrolyzed water (cleaning water): approx. 3/5 L/min (1 m head, 50/60 Hz)
Tank Capacity	Acidic electrolyzed water (sanitizing water): approx. 12 L (effective tank capacity approx. 10.6 L); Alkaline electrolyzed water (cleaning water): approx. 12 L (effective tank capacity approx. 10.6 L)
Exterior Dimensions	W: 400 mm x D: 420 mm x H: 345 mm
Acidic Water Neutralizer	Neutralization of acidic water overflow with neutralizing agent (max. capacity approx. 2 kg)
Chlorine Gas Treatment	Chlorine gas treatment with chlorine gas absorbing agent
Weight	Approx. 19 kg (approx. 23 kg packaged)
Usage Conditions	Ambient temperature range 5-35°C, within ±10% of rated voltage

<Important Notes>
 1. Grounding is mandatory. 2. Used only when connected to ROX-10WB electrolyzed water production system. Due to the possibility of back flows due to siphoning, be sure that the TDT-15WB2 is set up lower than the ROX-10WB. 3. The neutralizing agent is a consumable-replenish regularly. Use only genuine Hoshizaki neutralizer, and maintain level above the MIN line. 4. Chlorine gas absorbing agent must be replaced annually or after every 360 hours of operation. 5. Notes regarding installation requirements: Ensure system is used properly in accordance with conditions regarding placement, water supply and drainage, power supply, and other stipulations in the operation manual and installation manual. As actual space for installation may differ slightly, allow approximately 10 mm additional space in dimensions (space for ventilation and piping is in addition to the space required for installation of the unit).

Piping Diagrams

